

Drawing Location/Name: T:\Projects\2020\0402\_Wintrust Bank Oak Park\20402\_WORKING\AUTOCAD\SHEETS\101\_Landscape Plan.dwg Last Modified: Nov 12, 2020 - 2:38pm Plotted On: Nov 12, 2020 - 2:38pm Plotted By: rkaiser

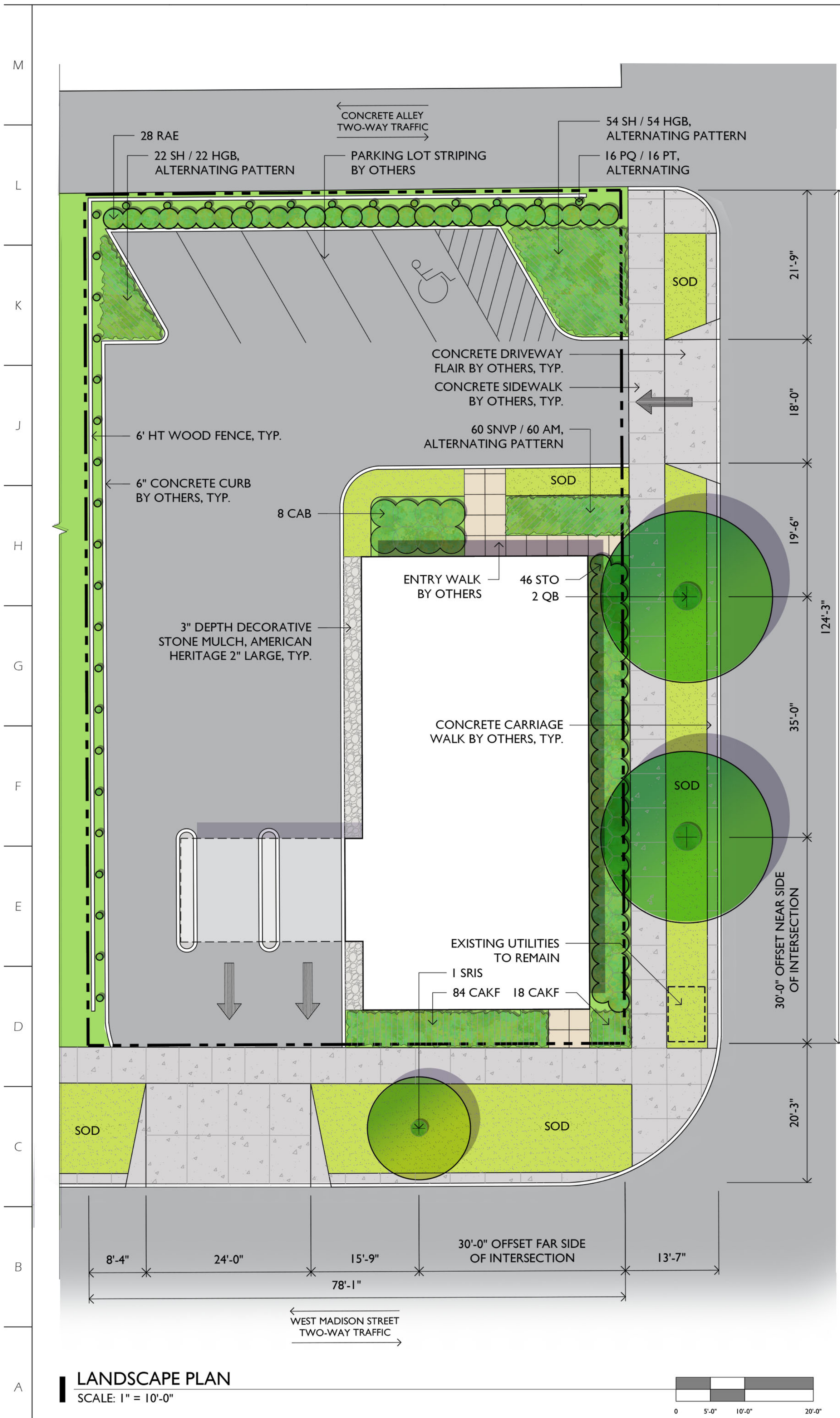

|             | CODE | BOTANICAL NAME                           | COMMON NAME                      | QTY | CAL | HT  | SPRD | ROOT | REMARKS  |
|-------------|------|--|----------------------------------|-----|-----|-----|------|------|--|
| SHADE TREES | QB   | QUERCUS BICOLOR                          | SWAMP WHITE OAK                  | 2   | 4"  | -   | -    | B&B  | SINGLE STRAIGHT TRUNK, SPECIMEN QUALITY, SPRING DIG ONLY |
|             | SRIS | SYRINGA RETICULATA 'IVORY SILK'          | IVORY SILK JAPANESE TREE LILAC   | 1   | 4"  | -   | -    | B&B  | SINGLE STRAIGHT TRUNK, SPECIMEN QUALITY                  |
| GRASSES     | CAB  | CORNUS ALBA 'BAILHALO'                   | IVORY HALO VARIEGATED DOGWOOD    | 8   | -   | 30" | -    | #5   | 4'-0" ON CENTER  |
|             | RAE  | RIBES ALPINUM 'EUROPA'                   | EUROPA ALPINE CURRANT            | 28  | -   | 24" | -    | #3   | 3'-0" ON CENTER  |
|             | STO  | SPIRAEA THUNBERGII 'OGON'                | SPIREA MELLOW YELLOW             | 46  | -   | 24" | 24"  | #5   | 3'-0" ON CENTER  |
|             | CAKF | CALAMAGROSTIS ACUTIFLORA 'KARL FOERSTER' | KARL FOERSTER FEATHER REED GRASS | 102 | -   | -   | -    | #1   | 1'-6" ON CENTER  |
| PERENNIALS  | SH   | SPOROBOLUS HETEROLEPIS                   | PRAIRIE DROPSEED                 | 76  | -   | -   | -    | #1   | 1'-6" ON CENTER  |
|             | AM   | ALLIUM 'MILLENIUM'                       | ORNAMENTAL ALLIUM                | 60  | -   | -   | -    | #1   | 1'-0" ON CENTER  |
|             | HGB  | HEMEROCALLIS 'GOING BANANAS'             | GOING BANANAS DAYLILY            | 76  | -   | -   | -    | #1   | 1'-6" ON CENTER  |
|             | SNVP | SALVIA NEMEROSA 'VIOLET PROFUSION'       | VIOLET PROFUSION SALVIA          | 60  | -   | -   | -    | #1   | 1'-0" ON CENTER  |
| VINES       | PQ   | PARTHENOISSUS QUINQUEFOLIA               | VIRGINIA CREEPER                 | 16  | -   | -   | -    | QT   | 6'-0" ON CENTER, ALTERNATING                             |
|             | PT   | PARTHENOISSUS TRICUSPIDATA               | BOSTON IVY                       | 16  | -   | -   | -    | QT   |  |

**2 PLANT PALETTE**

NOTE: QUANTITIES ON THE PLANT LIST ARE PROVIDED FOR INFORMATION ONLY. PLANT QUANTITIES UNDER THE CONTRACT ARE INDICATED ON THE PLANS. IN THE EVENT OF ANY DISCREPANCIES, THE CONTRACT SHALL BE BASED ON THE QUANTITIES SHOWN ON THE PLANS.

**WEST MADISON STREET**

LENGTH (LINEAR FEET) 78'-1"  
 NUMBER OF TREES REQUIRED (1 PER 35 LF) 2  
 NUMBER OF EXISTING TREES TO REMAIN 0  
 NUMBER OF ADDITIONAL TREES TO BE PROVIDED 1 TREE IS PROVIDED. ADDITIONAL TREES BEYOND THIS NUMBER CANNOT BE PROVIDED DUE TO THE PROXIMITY OF THE INTERSECTION AND DRIVEWAY.

**SOUTH RIDGELAND AVENUE**

LENGTH (LINEAR FEET) 124'-3"  
 NUMBER OF TREES REQUIRED (1 PER 35 LF) 3  
 NUMBER OF EXISTING TREES TO REMAIN 0  
 NUMBER OF ADDITIONAL TREES TO BE PROVIDED 2 TREES ARE PROVIDED. ADDITIONAL TREES BEYOND THIS NUMBER CANNOT BE PROVIDED DUE TO THE PROXIMITY OF THE INTERSECTION AND DRIVEWAY.

**3 LANDSCAPE ORDINANCE ANALYSIS - PARKWAY PLANTING**

COPYRIGHT © 2020. ALL INFORMATION CONTAINED ON THIS DRAWING INCLUDING, BUT NOT LIMITED TO, DESIGN CONCEPTS AND DETAILS IS THE PROPERTY OF GRUND & RIESTERER ARCHITECTS, INC. ALL 2020 DOCUMENTED HEREIN WERE CREATED AND DEVELOPED FOR THIS SPECIFIC PROJECT AND SHALL NOT BE REUSED IN ANY FORM WITHOUT WRITTEN PERMISSION OF GRUND & RIESTERER ARCHITECTS, INC.

|               |                 |                  |
|---------------|-----------------|------------------|
| 01            | 11/13/20        | ZONING REVIEW    |
| NO.           | DATE            | REASON FOR ISSUE |
| DRAWN BY: RLK | CHECKED BY: CAS |                  |

CONSULTANTS

PROJECT TITLE  
 OAK PARK BANK & TRUST  
 400 MADISON ST.  
 OAK PARK, IL 60302  
 GNR PROJECT NO.: 2003.00

**GRUND & RIESTERER ARCHITECTS, INC.**

THE CIVIC OPERA BUILDING 20 NORTH WACKER DRIVE  
 SUITE 2418 CHICAGO, ILLINOIS 60606  
 T: 312-372-5353 F: 312-372-5367  
 E: GNRARCH@GNRARCH.COM  
 I: WWW.GNRARCH.COM